



EasyBase Assembly for 6-Legged Table Bases



Important! Read the entire directions and study the pictures before you start your assembly — it makes all the difference. *Matthew Burak*

Here's what's included in your 6-legged table base kit.

Your legs and aprons may be a different size or style than shown in the photos. Not to worry—the assembly is the same. All parts are pre-drilled and ready to assemble.

- A:** Corner table legs (4)
- B:** Middle table legs (2)
- C:** Long side aprons (2)
- D:** Long side aprons with long tenons (2)
- E:** Table end aprons (1)
- F:** Middle apron (1)
- G:** Corner blocks (6)
- H:** Mounting bolts and washers (12)
- I:** 1 1/2" square head wood screws (4)
- J:** 6" #2 square head drill bit (1)
- K:** Allen (hex) wrench (1)

You'll also need...

- electric drill
- A smooth, flat surface to assemble the kit that is **larger than the finished base**. If you already have a table top, you can assemble the base directly on the overturned top.

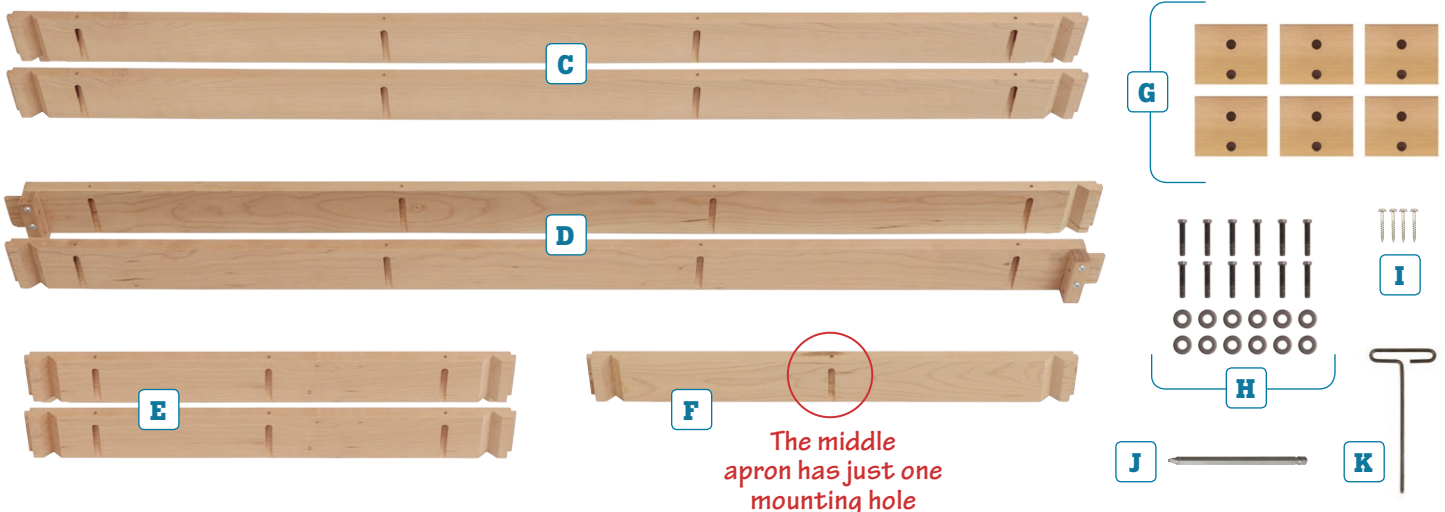
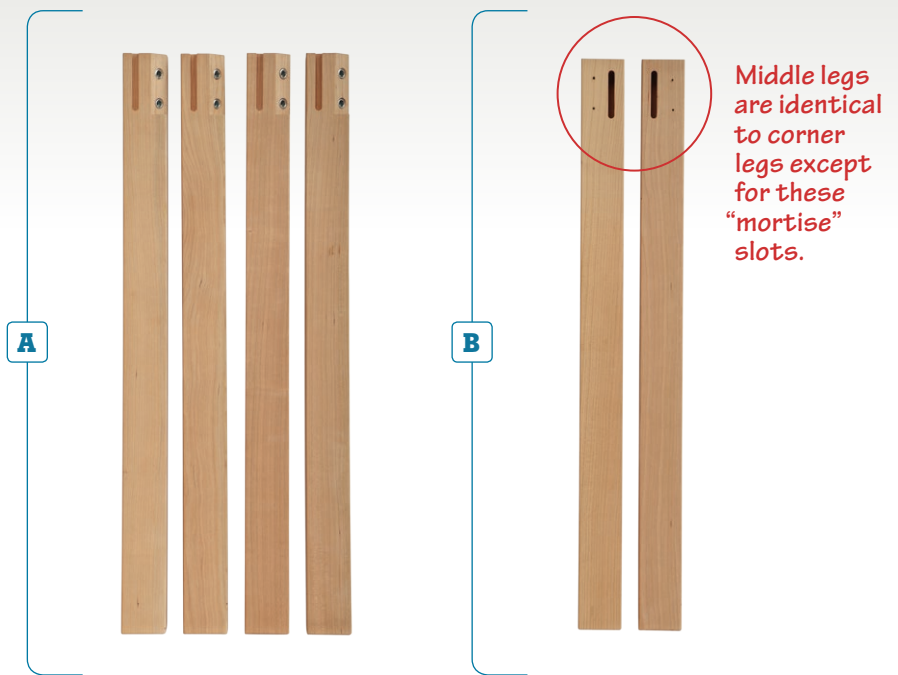

I

Start by building half the table base.

Assemble your parts upside down on a smooth, flat surface that is larger than the table base you're building.

1: Lay out four aprons.

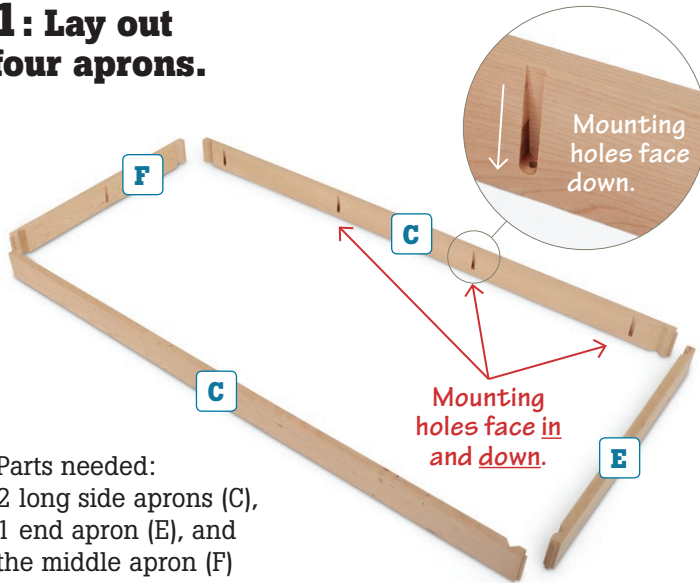

Parts needed:
2 long side aprons (C),
1 end apron (E), and
the middle apron (F)

2: Position two corner legs.

Parts needed:
2 corner legs (A)

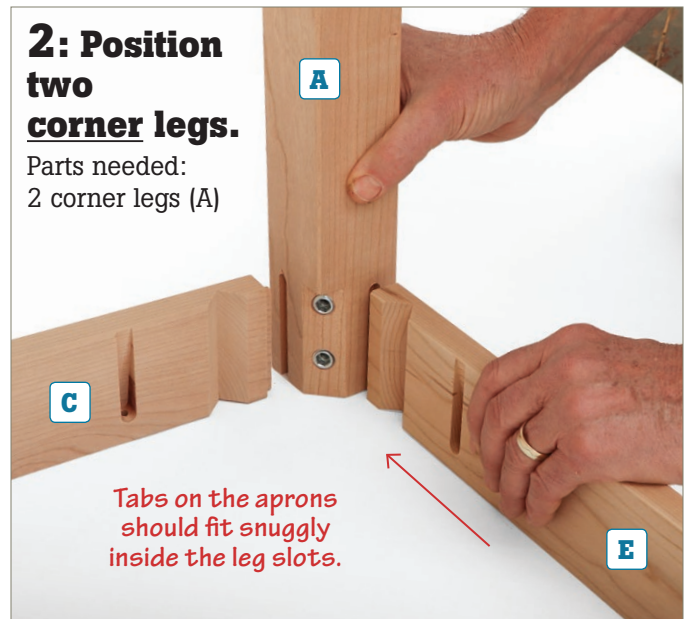

3: Install two corner blocks.

Parts needed:
2 corner blocks (G) and
4 bolts with washers (H)

3A: Align and "seat" the corner blocks

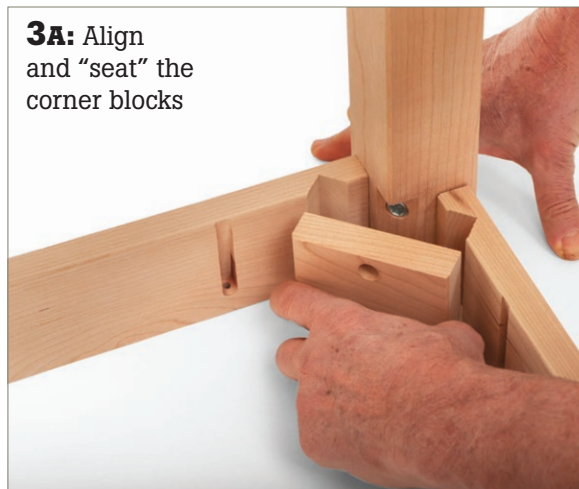

3B: Insert bolts and washers. Finger tighten before tightening with the supplied wrench.



3C: Using the supplied wrench, tighten each bolt until it stops turning and the wrench handle begins to spring back.



The base with the first two corner legs installed should look like this.

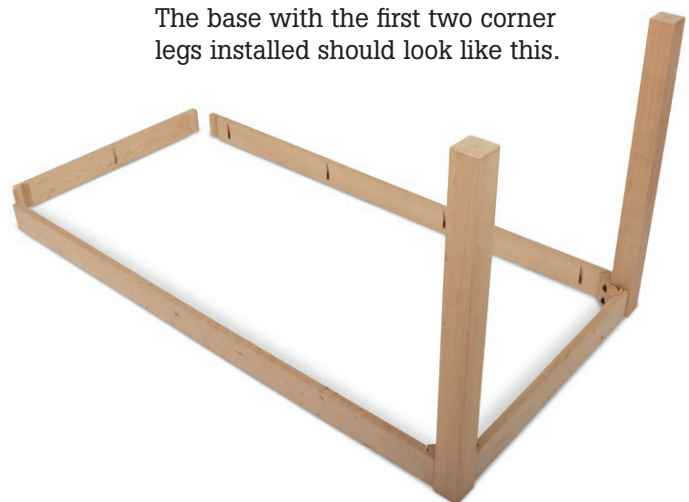

4: Position and install middle legs.

Parts needed: 2 middle legs (B), 2 corner blocks (G), and 4 bolts with washers (H). Repeat steps 3 to install corner blocks.



Your half-complete base should look like this.

II

Install the remaining aprons and legs.

5: Lay out the two remaining long-side aprons.

Parts needed: 2 long side aprons with tenons (D)

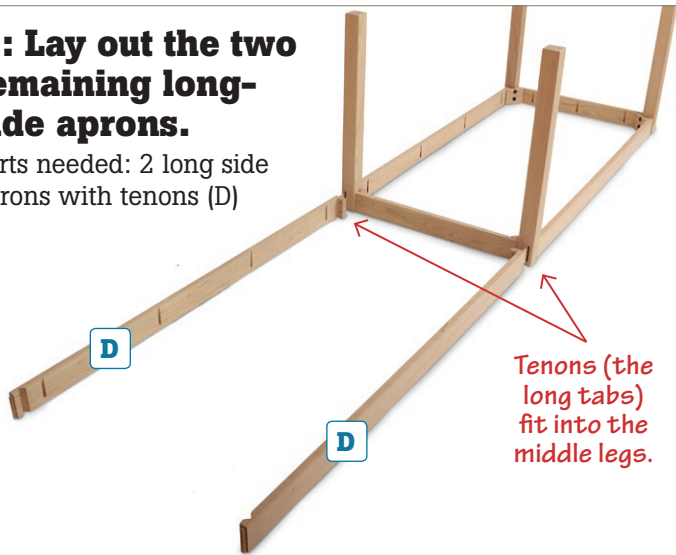

Tenons (the long tabs) fit into the middle legs.

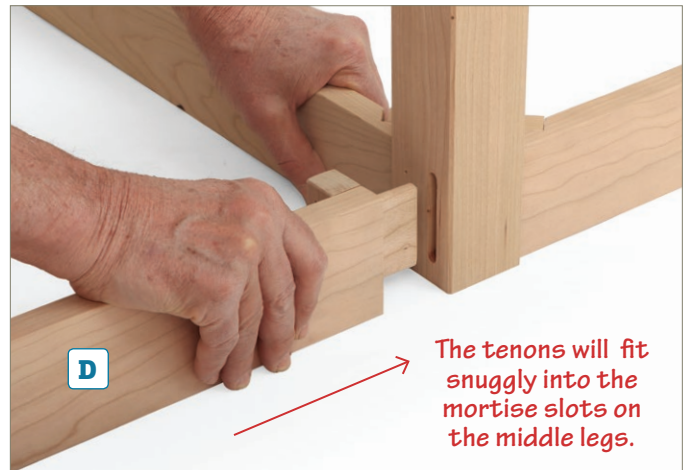

The tenons will fit snugly into the mortise slots on the middle legs.

6: Insert aprons into middle legs.

7: Attach aprons to middle legs.

Parts needed: 4 wood screws (I) and a drill or screwdriver with square bit



The wood screws will line up with the pre-drilled holes in the middle leg.



The assembled middle joints should look like this.

8: Position and install the remaining end apron and two remaining legs.

Parts needed:

1 end apron (E),
2 corner legs (A),
2 corner blocks (G),
and 4 bolts with
washers (H)

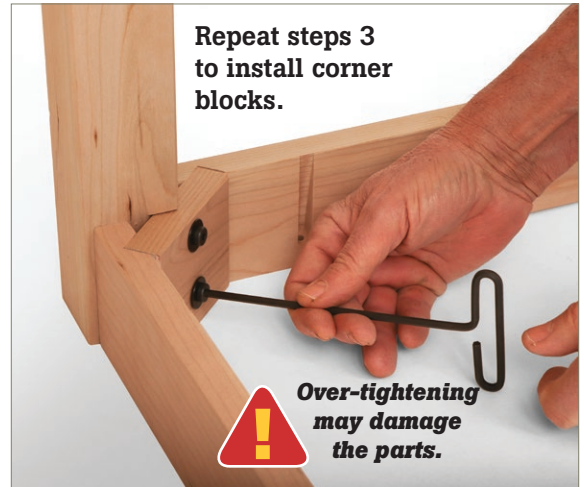
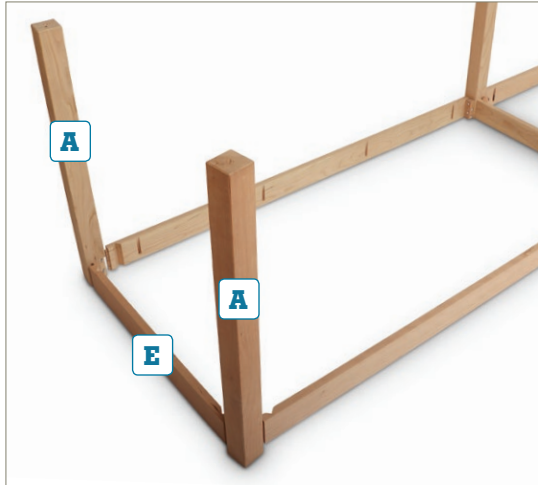

III

Turn your base right-side up, check fit.



Be careful not to damage the base at this point—it will be much sturdier once the top is installed. Get someone to help!

9: With the base in its upright position, carefully check the fit of all parts!



Corners that are out of alignment will weaken the assembly and make it impossible to correctly mount your table top.

Incorrect alignment.

Fine-tune the fit by loosening the bolts a bit and tapping the leg, aprons and corner blocks into place. Then re-tighten the bolts.



Correct alignment.



TableLegs.com

CLASSIC DESIGNS
by MATTHEW BURAK

84 Central Street, St. Johnsbury, Vermont 05819
800-748-3480 | email: legs@tablelegs.com
Hours: Monday-Thursday: 8 a.m.–6 p.m., Friday: 8 a.m.–5 p.m., EST